

Technical specifications

HC-ACC-CLSET (Clamping set raised floor)

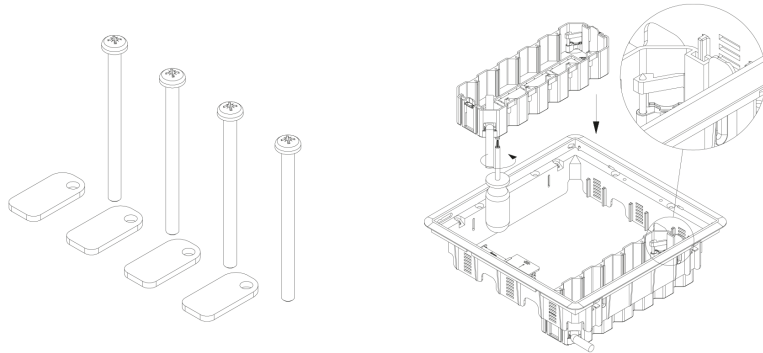

Category:

HC-ACC-CLSET

Product features:

Additional product information:

For the fixation of the service unit by means of clamping under the floor tile
Clamping range: 20-50mm
Other clamping ranges on demand

Execution:	Pre-galvanized							
Product	Number	Height (mm)	Width (mm)	Length (mm)	Dim A (mm)	Fmax (kN)	Unit	Packaging (unit)
FS-HC-CLSET-RF-0-0-PG	15779						ST	1

Peripheral information:

Equipotential bonding: EN50085

EC conformity: EC directive 2006/95/EC (Low voltage) as modified by directive 93/68/EEC (CE marking)